



JEREMY JAMES

HARLEY HOUSE, LONDON, W1.



PRICE

£95,000 per annum

FURNINSHINGS

Unfurnished

33 New Cavendish Street
London,
W1G 9TS

020 7486 4111
jeremyjames@jeremy-james.co.uk



JEREMY JAMES

HARLEY HOUSE, LONDON, W1.



DESCRIPTION

Unique medical suite available which would make an ideal Central London Clinic. The suite offers huge potential and viewing is strongly recommended.

AMENITIES

Self contained suite.

Video Entry

24 Hour Porterage

HCC Compliant

One Parking Space (outside of Congestion Zone)



APPROX GROSS INTERNAL FLOOR AREA
1022 SQ.FT (95 SQ.M.)

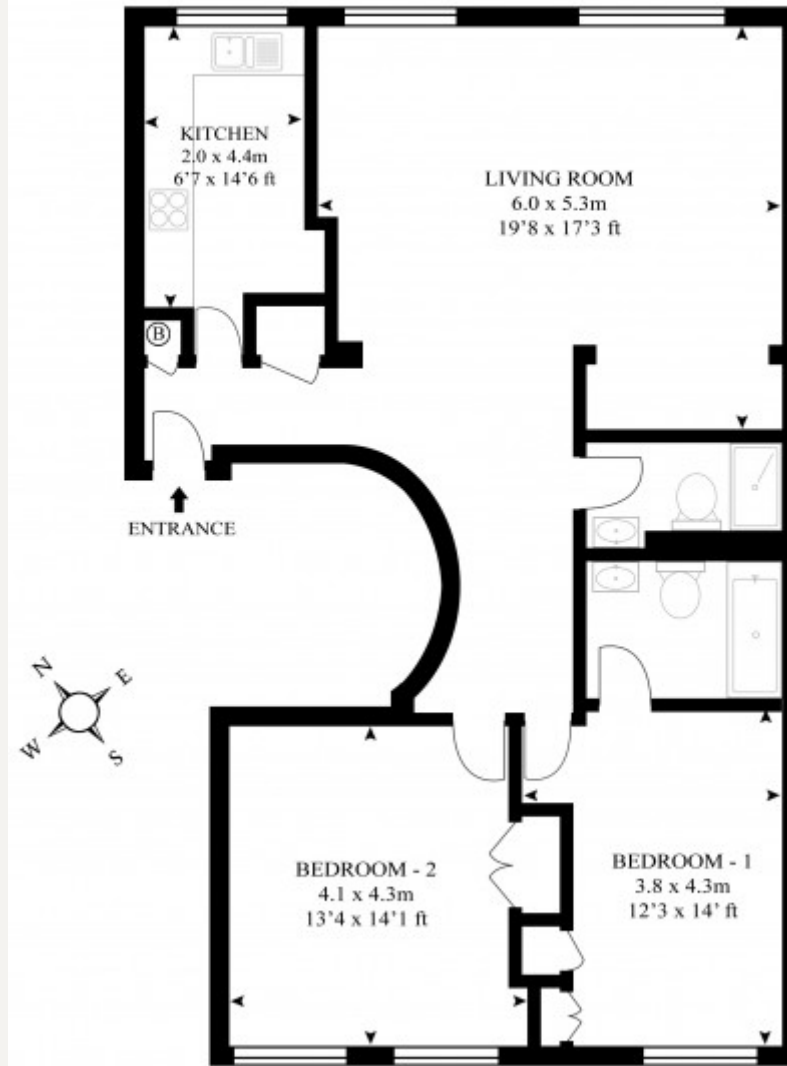



JEREMY JAMES

HARLEY HOUSE, LONDON, W1.

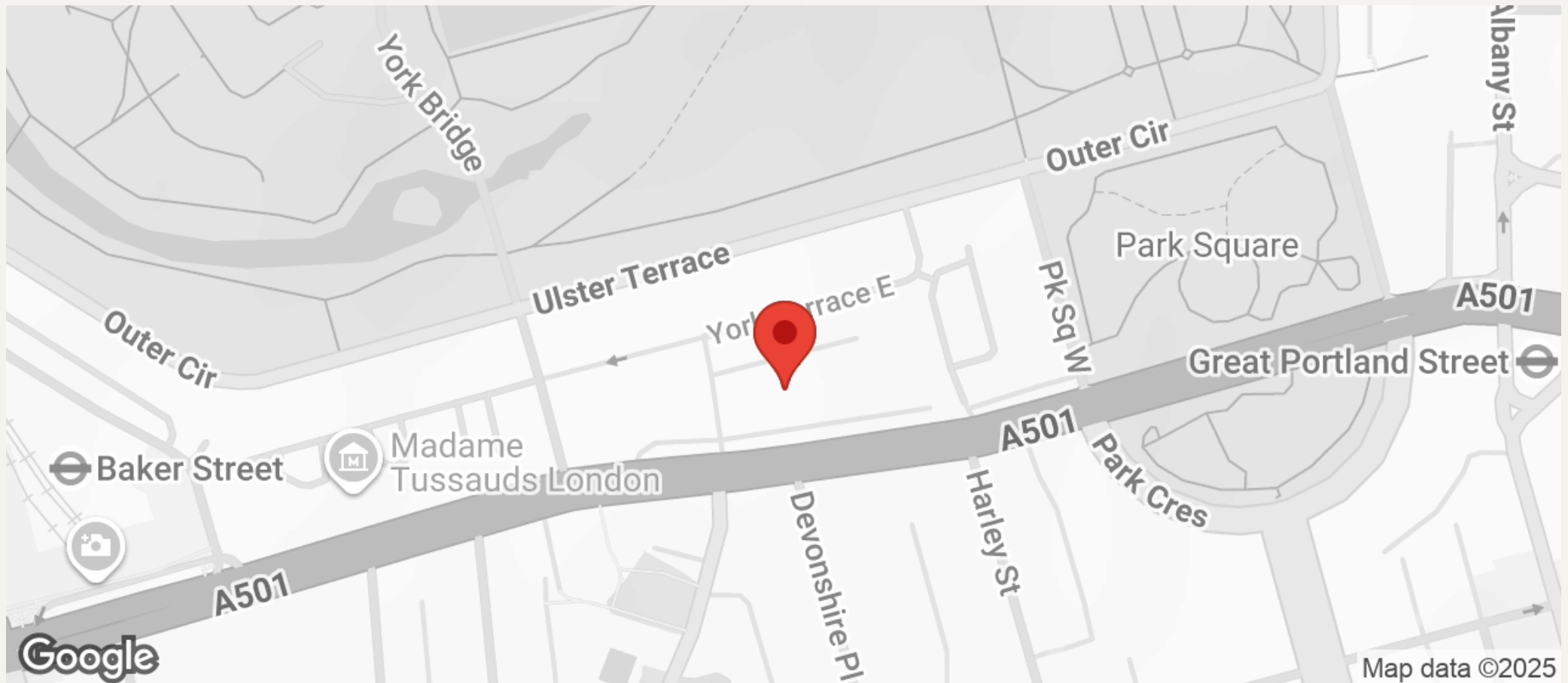

All negotiations are subject to contract. The Agents are not authorised to make or accept any contractual offer unless prior written notification to the contrary has been given on behalf of the client. In no other case whatsoever are the Agents (or any employee or sub-agent) authorised to make or give any representation or warranty on behalf of any party, and whilst information and particulars are given in all good faith intending purchasers and lessees must satisfy themselves independently as to the accuracy of all matters upon which then intend to rely. Measurements or distances referred to are approximately only. We have not carried out a survey or tested the services, appliances or specific fittings.

33 New Cavendish Street
London,
W1G 9TS
020 7486 4111
jeremyjames@jeremy-james.co.uk