



**JEREMY JAMES**

**MARYLEBONE STREET, MARYLEBONE VILLAGE, LONDON W1**



**PRICE**

£1,395,000

**TENURE**

Leasehold

33 New Cavendish Street  
London,  
W1G 9TS

020 7486 4111  
[jeremyjames@jeremy-james.co.uk](mailto:jeremyjames@jeremy-james.co.uk)



# JEREMY JAMES

## MARYLEBONE STREET, MARYLEBONE VILLAGE, LONDON W1



### DESCRIPTION

The building is located on the west side of Marylebone Street close to the junction with Weymouth Street. The building benefits from a communal garden. Bond Street and Baker Street underground stations together with the shopping facilities of Marylebone High Street are within close proximity. The open spaces of Regents Park are also nearby.

### AMENITIES

2 Bedrooms

Moments from Marylebone High Street

Day Porter

Access to communal gardens



33 New Cavendish Street  
London,  
W1G 9TS

020 7486 4111  
[jeremyjames@jeremy-james.co.uk](mailto:jeremyjames@jeremy-james.co.uk)



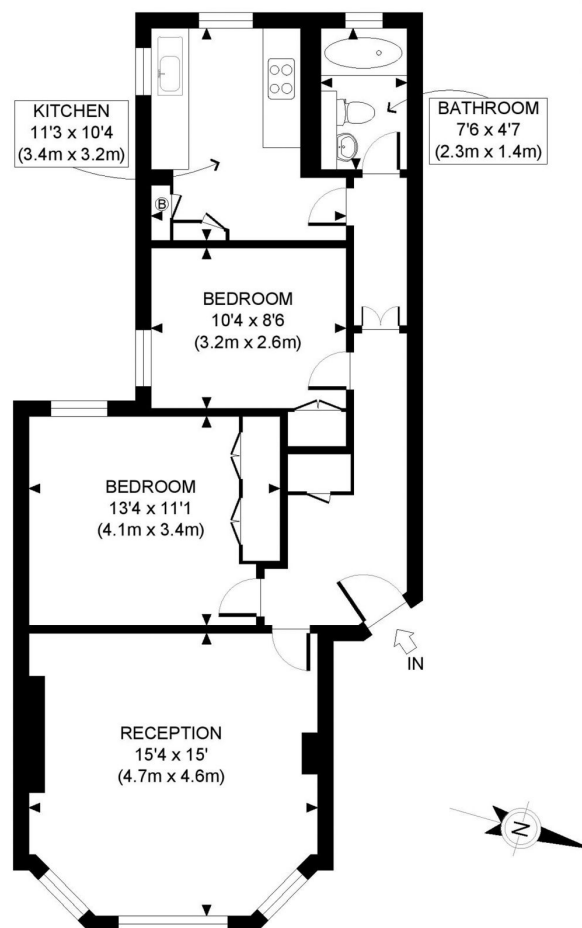

RAISED GROUND FLOOR  
GROSS INTERNAL  
FLOOR AREA 733 SQ FT

APPROX. GROSS INTERNAL FLOOR AREA: 733 SQ FT/ 68 SQM

**PROPERTY PHOTO PLANS**.co.uk  
ONE STOP SHOP FOR PROPERTY MARKETING

Whilst every attempt has been made to ensure the accuracy of the floor plan contained here, measurements of the doors, windows, rooms and any other items are approximate and no responsibility is taken for any errors, omissions, or miss-statement. This plan is for illustrative purposes only and should be used as such by any prospective client. The services, systems and appliances shown have not been tested and no guarantee as to the operability or efficiency can be given.



JEREMY JAMES

MARYLEBONE STREET, MARYLEBONE VILLAGE, LONDON W1

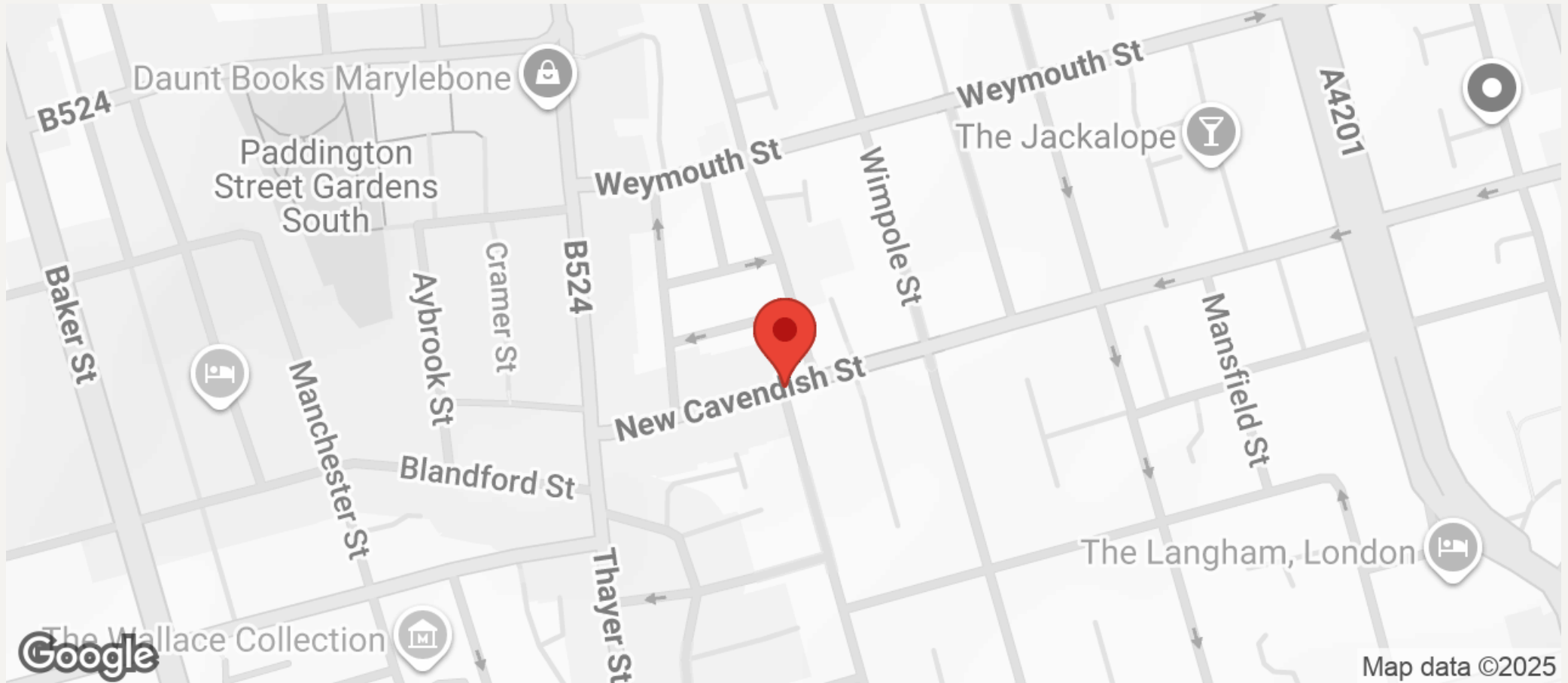

All negotiations are subject to contract. The Agents are not authorised to make or accept any contractual offer unless prior written notification to the contrary has been given on behalf of the client. In no other case whatsoever are the Agents (or any employee or sub-agent) authorised to make or give any representation or warranty on behalf of any party, and whilst information and particulars are given in all good faith intending purchasers and lessees must satisfy themselves independently as to the accuracy of all matters upon which then intend to rely. Measurements or distances referred to are approximately only. We have not carried out a survey or tested the services, appliances or specific fittings.

33 New Cavendish Street  
London,  
W1G 9TS

020 7486 4111  
jeremyjames@jeremy-james.co.uk